

Grassmere Way, Pillmere, Saltash, PL12 6YU

Guide Price £135,000

🛏️ 2 🚗 1 🚲 1



A fantastic opportunity to purchase a two bedroom first floor apartment, on the popular Pillmere Estate in Saltash, Cornwall. This wonderful property light and airy throughout and would make an excellent first time buy or investment! Additional features include: an allocated off road parking space, modern kitchen, spacious lounge/diner, two double bedrooms, communal gardens and tidy common areas. Call today to book your viewing!

Key Features

- Leasehold - EPC TBC - Council Tax Band B
- Ground Rent £125pa
- Allocated Parking Space
- Spacious Lounge/Diner
- Fantastic First Time Buy or Investment!
- Service Charge £1,140pa
- 106 Year Lease
- Two Double Bedrooms
- Contemporary Kitchen & Bathroom
- To Book a Viewing Quote BH0675

Ground Floor

Approx. 54.1 sq. metres (582.0 sq. feet)

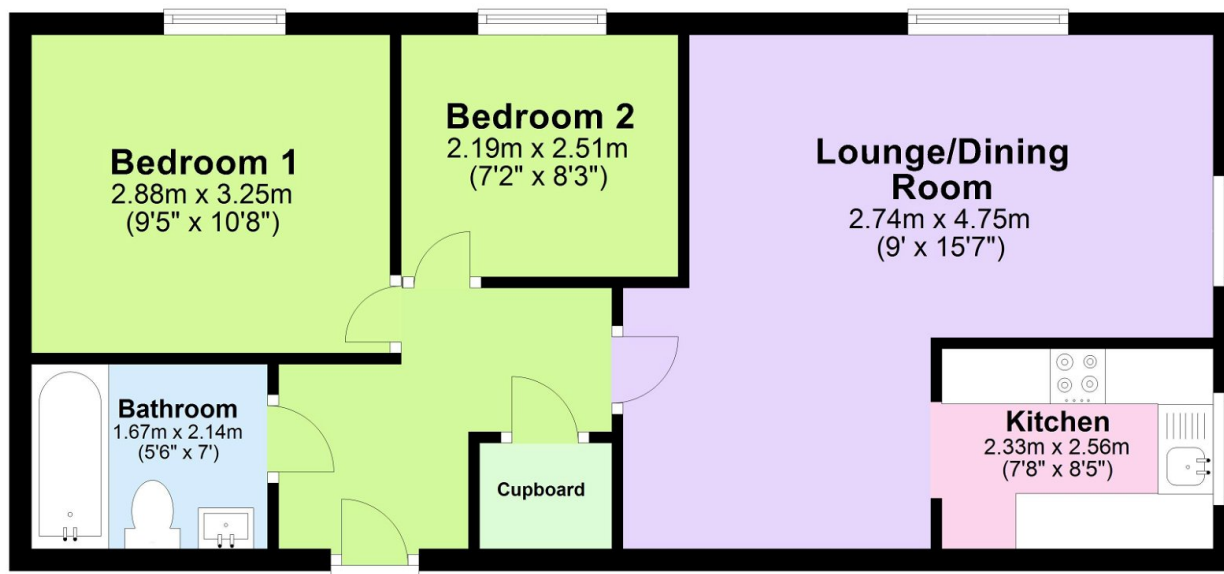

Total area: approx. 54.1 sq. metres (582.0 sq. feet)